



EASA
This is it

PRECISE ENGINEERING AND PERFORMANCE

FREIGHT ELEVATORS

A B O U T E A S A

V I S I O N & V A L U E

To be your first choice in designing, supplying, installing and maintaining the Freight Elevators. We are motivated with technological advances and are keen to supply quality material. We invest in progress and innovation.

EASA believes in health and safety of our Customers, Employees and Users. We motivate, support and participate.

C U S T O M E R C O M M I T M E N T

Thanks to our qualified team, we are able to guarantee world class products and work in terms of "Safety & Ride Quality" today.

EASA caters to individual needs of each customer in terms of Installation, Designs, Cabin Interiors, Type of doors and we also create customised products for each project with the best solutions.

M A R K E T L E A D E R S H I P

With over two decades of experience EASA has established as a leading Company in the design, manufacturing, sales and installation of all type of Passenger Elevators, Panoramic Elevators, Freight Elevators, Automobile Elevators, Dumb Waiters, and Elevators in Steel Structures. EASA has its own manufacturing facility and independent logistic facility at Khushkhera.

INNOVATION & ECO DESIGN

Constant Innovation in Technology with Environment Criteria has resulted in High speed lifts with Low powered Gearless Machines, hence minimising the environmental impact.

DPC The Innovative "Design Product Concept" for the lift Interiors has added a new dimension of a "Lifestyle Product" for your building. The designs are breathtaking, very sturdy, fire resistant and never seen before.

SERVICES

A motivated team of engineers, technicians and call centre is pressed into service to ensure a trouble free operation. We have achieved the highest uptime in the industry.

We offer comprehensive Maintenance package at reasonable rates.



HOW TO CHOOSE YOUR FREIGHT ELEVATOR

The lift rules demand an Elevator is to be installed as per IS specifications 14665 in force (Elevator has to be of a traction type system) and the elevator should be safe for the travel of both Freight & Passengers.

WEIGHT & VOLUME

First calculate the amount of material that is to be lifted both in terms of Weight & Volume per day and per hour movement of the material.

Consider the following while calculating the Capacity

- i. Time taken to load and time taken to unload the material
- ii. Time taken for elevator travel between the bottom most to top most floor.

Elevator Travel – The general speed for Freight Elevators is 0.25 Meters/second (15 meters/minute) and other elevators are designed for higher speeds like 0.30, 0.50 & 1.0 Meter/second

Note: Since the loading /unloading time is generally quite high, Freight Elevator are recommended with low speeds to economise the unit price and running costs.

CAPACITY, SIZE AS PER IS & INTERNATIONAL NORMS

General thumb rule is 453 Kg/Sq. mtr of floor area of the cabin is the prescribed capacity of the elevator as IS Specifications. However a 5-10% variation is acceptable.

LOADING & ORIENTATION

FRONT LOADING: Only one side loading and unloading on all floors.

FRONT & REAR (OPPOSITE) LOADING/UNLOADING: Loading on either front side or rear side from any floors.

FRONT & SIDE LOADING /UNLOADING (90°): Loading from front side and unloading from Right/Left side.

TYPES OF DOORS

AUTOMATIC DOORS: These are becoming a general international standard. Most common are 4 Panel centre opening doors.

MANUAL DOORS: Most common Manual doors are collapsible doors. Please note the collapsible doors are perforated therefore are not allowed in states /cities where the lift act is in force (Chennai, Delhi, Kolkata, Mumbai, Bangalore, Ahmadabad). However the only state that permits collapsible doors is Haryana.

HOW TO CHOOSE YOUR FREIGHT ELEVATOR

INTERIORS

- **STAINLESS STEEL:** Stainless Steel interiors are a standard for industries like Food processing, Pharmaceuticals or Industries that require a clean room standard as per WHO.
- **MILD STEEL:** Mild Steel surface coated (Painted or Power coated) sheets are a general standard for the industry.

THE ELEVATOR MACHINE

- a. The static load comprising of weight cabin, counterweight and ropes etc. is many times over than the actual payload, hence the gearboxes have bigger worm wheels as the output shafts are larger in diameters to sustain the large Static Loads.
- b. There are specialized manufacturers for Elevator Gearboxes. Standard gearboxes are not recommended.

VARIABLE FREQUENCY VARIABLE VOLTAGE (VVVF DRIVES)

VVVF Drives are commonly used for soft, start & stop and more accurate floor leveling facility. You also save 30% energy (electrical Consumption) and improved mechanical efficiency.

SAFETY

Over speed Governors along with the Safety Brake stop the free fall of an elevator when the movement of the Car is over a speed of 20% of the rated speed of the elevator.

Other important safety is of a mechanical interlock and electrical interlock to prevent cabin movement when the door is open.

Many other safeties like reduced operational Voltage, limiting the elevator “up or down movement” from bottom most or top most floor. Buffer springs, emergency stop, battery backed alarm and light etc are mandatory.

ARD AUTOMATIC RESCUE DEVICE

Automatic rescue device is incorporated to rescue people stuck in the elevator during a Power Loss. This device is mandatory in the state of Haryana.

FREIGHT ELEVATOR WITH MANUAL DOORS

W A L L S

MILD STEEL
(Grey)



MILD STEEL
(Indian Ivory)



MILD STEEL
(Phiroza Blue)



STAINLESS STEEL
(Hairline Finish)



C H E C K E R E D P L A T E F L O O R I N G



MILD STEEL



STAINLESS STEEL



ALUMINIUM



FREIGHT ELEVATOR WITH AUTOMATIC DOORS

W A L L S

MILD STEEL
(Grey)



MILD STEEL
(Indian Ivory)



MILD STEEL
(Phiroza Blue)



STAINLESS STEEL
(Hairline Finish)



C H E C K E R E D P L A T E F L O O R I N G

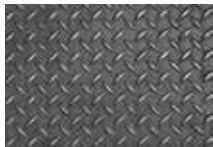

MILD STEEL



STAINLESS STEEL

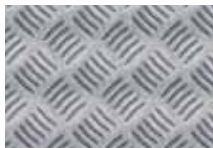

ALUMINIUM



FREIGHT ELEVATOR (MACHINE ROOM LESS)

LIFT WELL PLAN

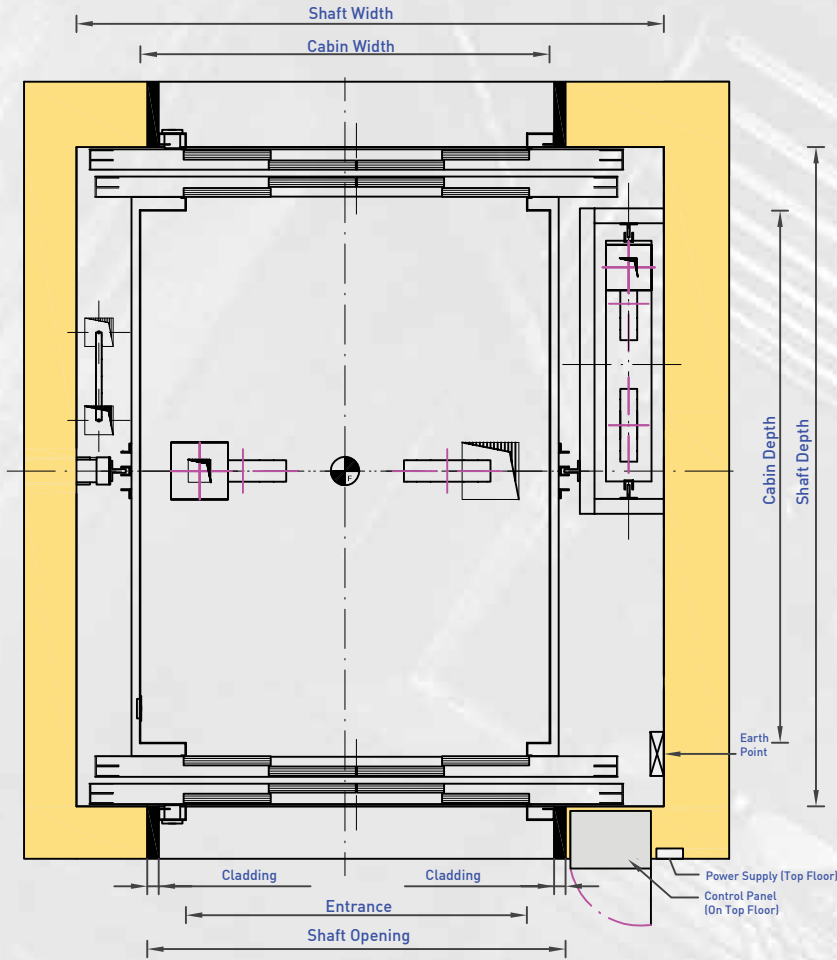

LIFT WELL ELEVATION

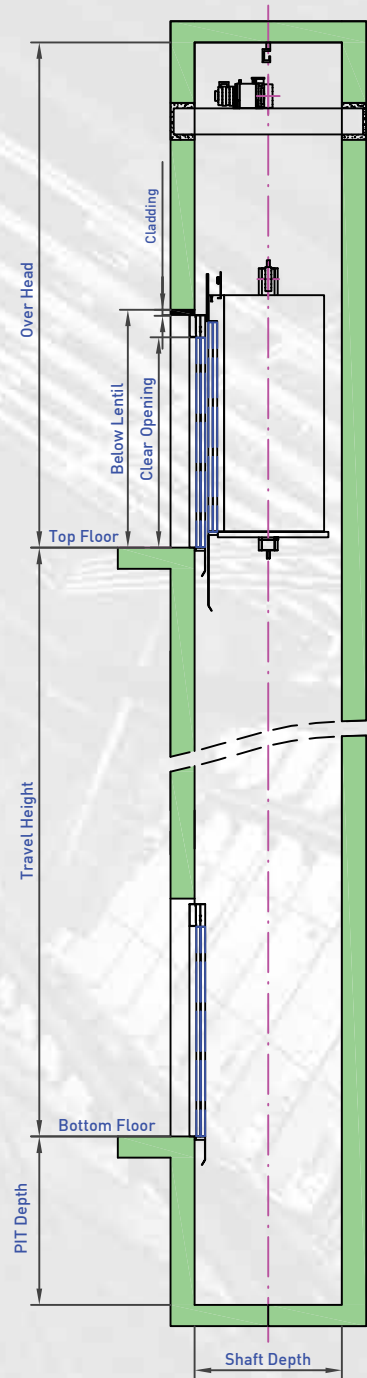

AUTOMATIC DOORS:

CAPACITY Kgs.	CAR INSIDE		LIFT WELL		ENTRANCE	
	WIDTH	DEPTH	WIDTH	DEPTH	WIDTH	HEIGHT
525	1100	1200	1875	1750	1000	2000
750	1200	1600	1950	2150	1000	2000
1050	1400	1800	2200	2350	1200	2000
1500	1700	2000	2550	2550	1500	2000
2025	1800	2500	2750	3050	1600	2000
2550	2000	2600	3000	3150	1800	2000
3000	2200	3000	3250	3550	2000	2000
3525	2200	3500	3250	4050	2000	2100
4050	2500	3500	3550	4050	2200	2100
5025	2600	4000	3650	4550	2300	2100

MANUAL OPERATED DOORS:

CAPACITY Kgs.	CAR INSIDE		LIFT WELL		ENTRANCE	
	WIDTH	DEPTH	WIDTH	DEPTH	WIDTH	HEIGHT
525	1100	1200	1800	1600	1000	2000
750	1200	1600	1900	2000	1000	2000
1050	1400	1800	2100	2200	1200	2000
1500	1700	2000	2400	2400	1500	2000
2025	1800	2500	2550	2900	1600	2000
2550	2000	2600	2800	3000	1800	2000
3000	2200	3000	3000	3400	2000	2000
3525	2200	3500	3000	3900	2000	2100
4050	2500	3500	3300	3900	2200	2100
5025	2600	4000	3400	4400	2300	2100

CAPACITY	LIFT SPEED METERS/SEC.	PIT DEPTH	OVER HEAD	CLEAR(DOOR) OPENING	BELOW LENTIL FROM Manual	BELOW LENTIL FROM Automatic
525 TO 2525 Kgs.	0.50 to 1.0	1600	5800	1000	2250	2460
2525 TO 4000 Kgs.	0.50 To 0.75	1800	6000	2000	2250	2460

NOTE :-

1. All dimensions are in millimeters.
2. All dimensions are for clear finished lift walls after plastering.
3. All walls minimum 150 RCC or 230 brick (hoist way front wall 230 brick preferred).
4. Power supply 400 volts, 3 phase, 4 wires, 50Hz and 230 volts 1 phase terminating in a MCCB/ECCB switch to be provided by clients.
5. For specific requirements our local representative will be happy to work with you in a preparation of working drawings.

FREIGHT ELEVATOR (MACHINE ROOM)

LIFT WELL & MACHINE ROOM PLAN

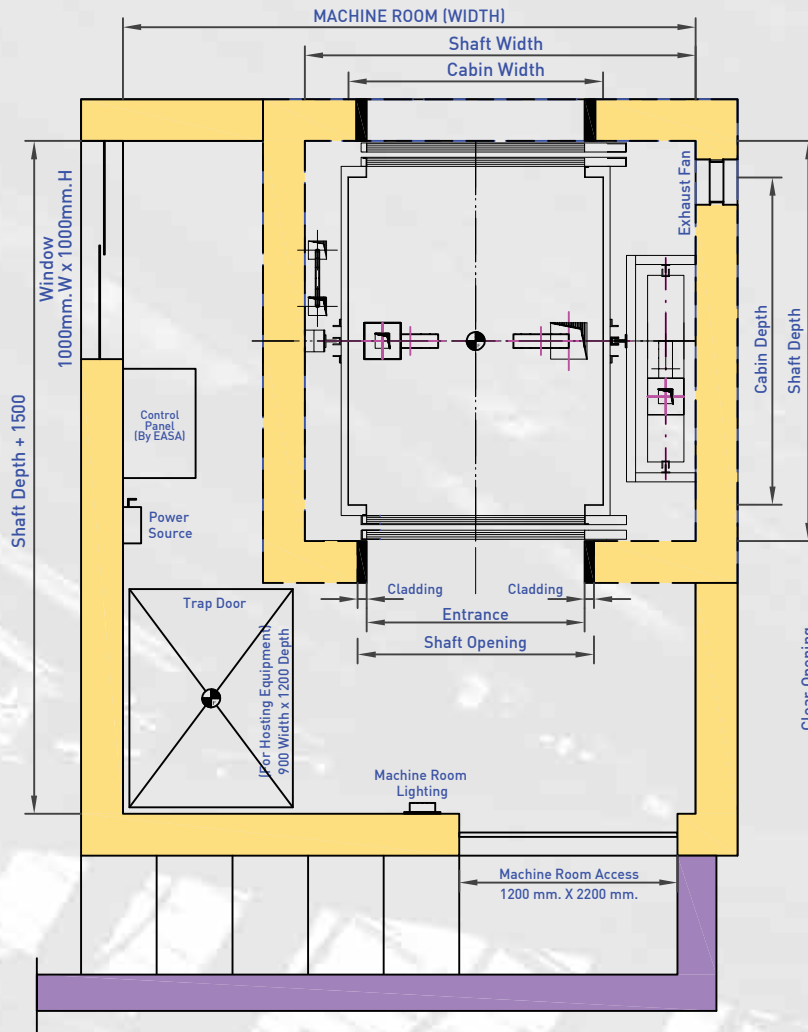

LIFT WELL ELEVATION

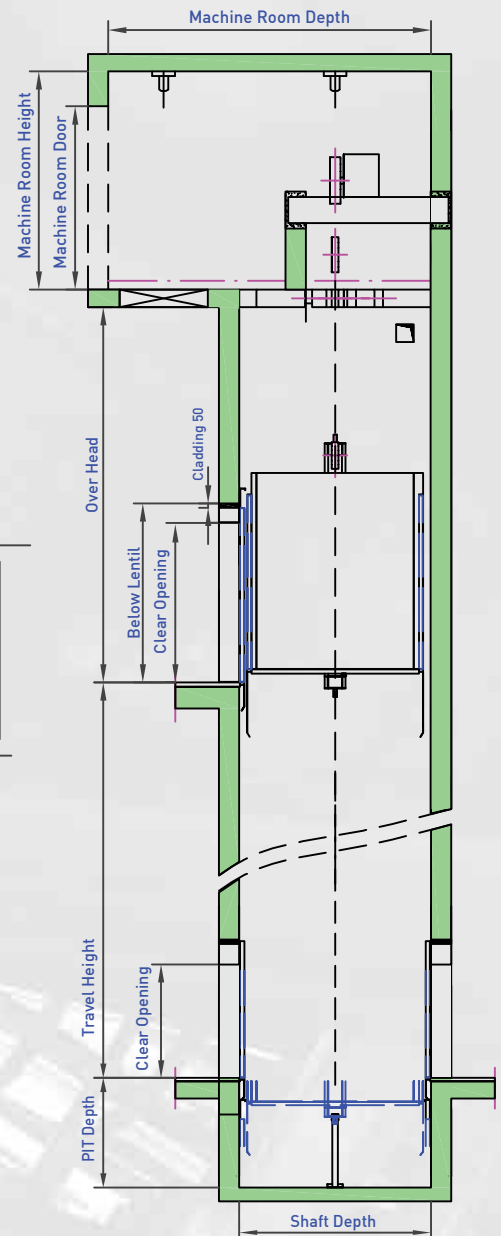

MANUAL OPERATED DOORS:

CAPACITY Kgs.	CAR INSIDE		LIFT WELL		ENTERANCE	
	WIDTH	DEPTH	WIDTH	DEPTH	WIDTH	HEIGHT
525	1100	1200	1800	1600	1000	2000
750	1200	1600	1900	2000	1000	2000
1050	1400	1800	2100	2200	1200	2000
1500	1700	2000	2400	2400	1500	2000
2025	1800	2500	2550	2900	1600	2000
2550	2000	2600	2800	3000	1800	2000
3000	2200	3000	3000	3400	2000	2000
3525	2200	3500	3000	3900	2000	2100
4050	2500	3500	3300	3900	2200	2100
5025	2600	4000	3400	4400	2300	2100

AUTOMATIC DOORS:

CAPACITY Kgs.	CAR INSIDE		LIFT WELL		ENTERANCE	
	WIDTH	DEPTH	WIDTH	DEPTH	WIDTH	HEIGHT
525	1100	1200	1875	1750	1000	2000
750	1200	1600	1950	2150	1000	2000
1050	1400	1800	2200	2350	1200	2000
1500	1700	2000	2550	2550	1500	2000
2025	1800	2500	2750	3050	1600	2000
2550	2000	2600	3000	3150	1800	2000
3000	2200	3000	3250	3550	2000	2000
3525	2200	3500	3250	4050	2000	2100
4050	2500	3500	3550	4050	2200	2100
5025	2600	4000	3650	4550	2300	2100

CAPACITY	LIFT SPEED METERS/SEC.	PIT DEPTH	OVER HEAD	CLEAR(DOOR) OPENING	BELOW LENTIL FROM Manual	BELOW LENTIL FROM Automatic
525 TO 2525 Kgs.	0.25 to 0.50	1600	4600	1000	2250	2460
2525 TO 4000 Kgs.	0.25 To 0.32	1800	4800	2000	2250	2460

NOTE :-

1. All dimensions are in millimeters.
2. All dimensions are for clear finished lift walls after plastering.
3. All walls minimum 150 RCC or 230 brick (hoist way front wall 230 brick preferred).
4. RCC machine room structural floor slab 150 thick designed to sustain minimum 1000 Kg./ M²UDL.
5. Power supply 400 volts, 3 phase, 4 wires, 50Hz and 230 volts 1 phase terminating in a MCCB/ELCB switch to be provided by clients.
6. For specific requirements our local representative will be happy to work with you in a preparation of working drawings.

OTHER PRODUCTS



EASA Passenger Elevators comprise of a wide range of Machine Room Less and Machine Room type of Elevators. We pioneer in Gearless machines and ECO friendly elevator installations. Standard and custom made elevators are designed as per your specific requirements.



Automobile Elevators are driven with heavy machines, and are used in automobile showrooms, workshops, parking lots, buildings, airports, garages etc.



Dumbwaiters are small service Elevators utilized in Homes, Hotels, Hospitals, Banquet Halls, Libraries, Industrial Kitchens, Departmental Stores & Restaurants etc. These lifts are used for transferring various materials between floor levels.



Stretcher Elevators are used in hospitals as part of medical care infrastructure. They have special features such as smooth jerk less travelling, low power consumption, accurate levelling, emergency control features and above all reliability with safety. The sturdy floors and interiors ensure convenience and longevity.



The technologically advanced Stairlift is helping thousands of people worldwide to reclaim full access to their homes. It's safe, comfortable and simple solution to ride the stairs. Every aspect of the Stairlift has been designed for the highest standards of comfort and safety.

OUR ALLIANCES

Fermator
AUTOMATIC DOORS FOR LIFTS

Spain
Automatic Doors

YASKAWA

Japan
Frequency Drives

Bharat Bijlee

India
Permanent Magnet Synchronous Motors

Nidec NIDEC CORPORATION
-All for dreams

China
Permanent Magnet Synchronous Motors

GG Gebauer & Griller

Austria
Travelling Cables & Cable Harness for
Elevators and Escalators

mik-el

Turkey
Controller Technology

MONTEFERRO

Italy
Guide Rail Systems

digipara
elevate your software

Germany
Lift Designer Software

REGISTERED TRADEMARKS of
EASA Elevators Private Limited

- EASA ®
- EASA ELEVATORS ®
 - EASA LIFTS ®
 - EASA SWIFT ®



EASA Elevators Private Limited

Head Office:

No.2, Aravali Complex, Rajiv Colony,
Near Rajiv Chowk, NH-8,
Gurgaon-122001, Haryana, India

Branch Office: Delhi

No. 119, U. S. Complex,
Opposite Apollo Hospital, Jasola,
New Delhi - 110076, India

Branch Office: Haridwar

No. 239, Avas Vikas Colony,
Ranipur; Haridwar - 249407,
Uttarakhand, India

Manufacturing Units:

Unit -1: G-1, 604-605 | Unit -2: F-625
RIICO Industrial Area, Khushkhera,
Dist. Alwar-300717, Rajasthan, India